



ADDCOM

ADD800/ADD880

Connecting the headset to your phone

Check to see whether your telephone has a dedicated headset socket.

- 1 If it doesn't your headset simply plus in at this point. In this case your telephone manufacturer has normally provided a headset button or headset feature with your telephone. Please refer to your telephone handbook for further details
- 2 If your telephone does not have a dedicated headset socket you will need to utilise the existing handset socket. Simply unplug the handset and plug in the headset.

Accessories such as the Addcom multi-purpose switch (01-00013) allow you to plug both the headset and the handset in simultaneously. Contact your supplier for more information.

Quick Disconnect (ADDQD)

Your headset is equipped with a ADDQD allowing you to walk away from your desk without removing your headset, freeing you to multitask.

- Before using your headset be sure the two halves of your ADDQD are connected.
- To unplug your headset, grasp either side of the ADDQD and pull apart.
- To resume your conversation, reconnect the two halves of the ADDQD.

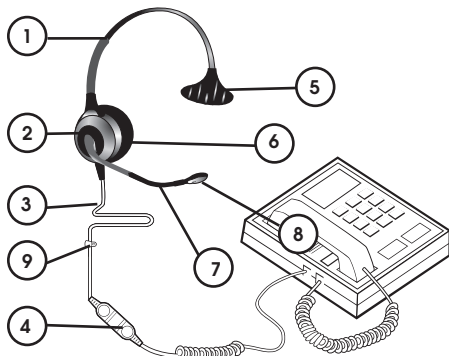

1. Adjustable headband
2. Receiver (speaker)
3. Headset cable
4. ADD Quick disconnect (ADDQD)
5. Adjustable t-bar
6. Ear cushion
7. Flexible microphone boom
8. Noise cancelling microphone
9. Clothing clip

Adjusting the Headband

Place the headset receiver to your ear(s) and set the T-bar above your other ear as shown. Adjust the clickstop headband until comfortable.



The ADD800/ADD880 may be worn on either ear, to switch sides simply rotate the microphone boom to the other side.

Adjusting the Microphone Boom

To adjust the microphone boom, bend the boom arm so the microphone is within 2cm of your mouth.



Adjusting the Clothing Clip

Fasten the clothing clip at a comfortable level. The cord should have sufficient slack so the headset is not disturbed by the movement of your head.

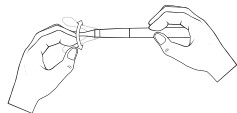

Safety Warning

Headset receiver may pickup sharp objects. This product should only be used with other approved equipment when connecting to the network.

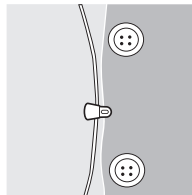

Please register your product at www.addcom.com
For troubleshooting and support please refer to www.addcom.com



RoHS
Compliant

