



# ADD COM<sup>®</sup>

# ADD300/ADD330

## Connecting the headset to your phone

Check to see whether your telephone has a dedicated headset socket.

- 1 If it doesn't, your headset simply plugs in at this point. In this case your telephone manufacturer has normally provided a headset button or headset feature with your telephone. Please refer to your telephone handbook for further details
- 2 If your telephone does not have a dedicated headset socket you will need to utilise the existing handset socket. Simply unplug the handset and plug in the headset.

*Accessories such as the ADDCOM multi-purpose switch allow you to plug both the headset and the handset in simultaneously. Contact ADDCOM or your supplier for more information.*

## Quick Disconnect (ADD-QD)

Your headset is equipped with an ADD-QD allowing you to walk away from your desk without removing your headset, freeing you to multi-task.

- Before using your headset be sure the two halves of your ADD-QD are connected.
- To unplug your headset, grasp either side of the ADD-QD and pull apart.
- To resume your conversation, reconnect the two halves of the ADD-QD.

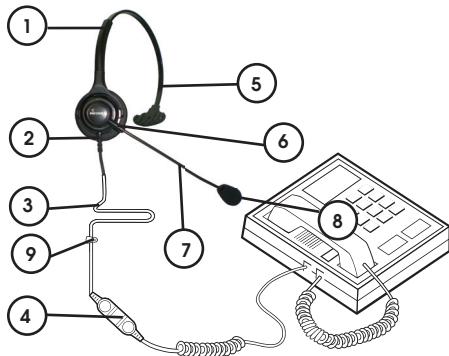

1. Adjustable headband
2. Receiver (speaker)
3. Headset cable
4. ADD Quick disconnect (ADD-QD)
5. Adjustable t-bar
6. Ear cushion
7. Flexible microphone boom
8. Noise cancelling microphone
9. Clothing clip

## Adjusting the Headband

Place the headset receiver to your ear(s) and set the T-bar above your other ear as shown. Adjust the clickstop headband until comfortable.



The ADD-300/ADD-330 may be worn on either ear. To switch sides simply rotate the microphone boom to the other side.

## Adjusting the Microphone Boom

To adjust the microphone boom, bend the boom arm so the microphone is within 2cm of your mouth.



## Adjusting the Clothing Clip

Fasten the clothing clip at a comfortable level. The cord should have sufficient slack so the headset is not disturbed by the movement of your head.

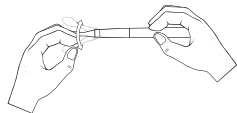

## Safety Warning

Headset receiver may pickup sharp objects. This product should only be used with other approved equipment when connecting to the network.

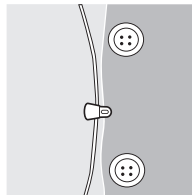

Please register your product at [www.addcom.com](http://www.addcom.com)  
For troubleshooting and support please refer to [www.addcom.com](http://www.addcom.com)



RoHS  
Compliant

